

Z73T**Z74T**

1 1/4"-1 1/2" | DN25-DN40 | CLASS 150/300

Floating Ball Flanged Up to 538°C (1000°F)

Valve dimensions

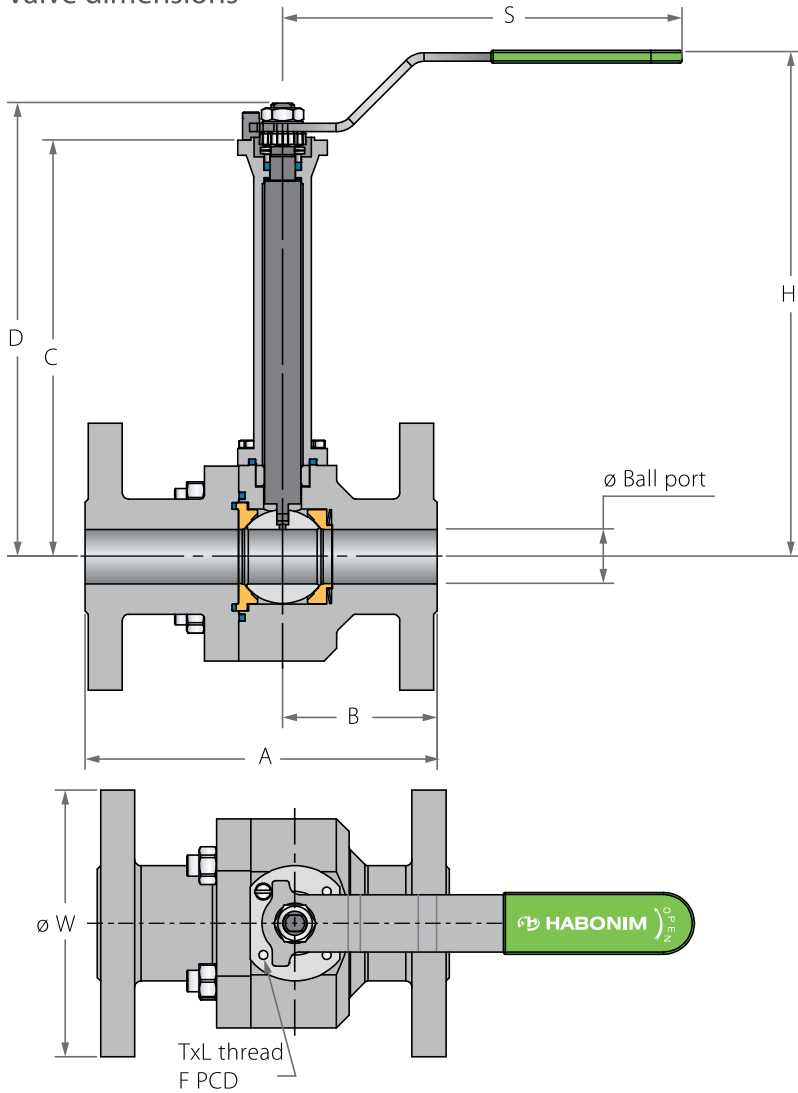

Preparation for actuation

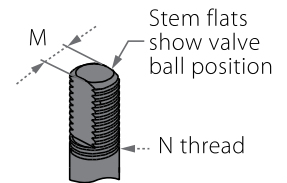
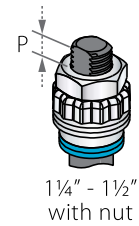

Std. port	Unit	Ball port	A		B		C	D	H	S	W		M	N	P	F	TxL	Weight kg/lb		Kv
			150	300	150	300					150	300						150	300	
DN32	mm	31.8	140	178	59	-	49.00	73	120.5	220.1	115	135	8.71	1/16" UNF	8.5 (F05)	50	M6x12	-	-	-
1 1/4"	inch	1.25	5.51	7.00	2.32	-	1.92	2.87	4.74	8.66	4.53	5.31	0.34	1/16" UNF	0.33	1.97	M6x12	-	-	-
DN40	mm	38.10	165.00	190.00	68.00	80.40	201.00	230.60	276.80	237.00	127.00	165.00	8.71	1/16" UNF	8.50 (F05)	50.00	M6x12	8.5	11.5	220
1 1/2"	inch	1.50	6.50	7.48	2.68	3.17	7.91	9.08	10.90	9.33	5.00	-	0.34	1/16" UNF	0.33	1.97	M6x12	18.7	25.3	255



Floating Ball Flanged Up to 538°C (1000°F)

Components & materials

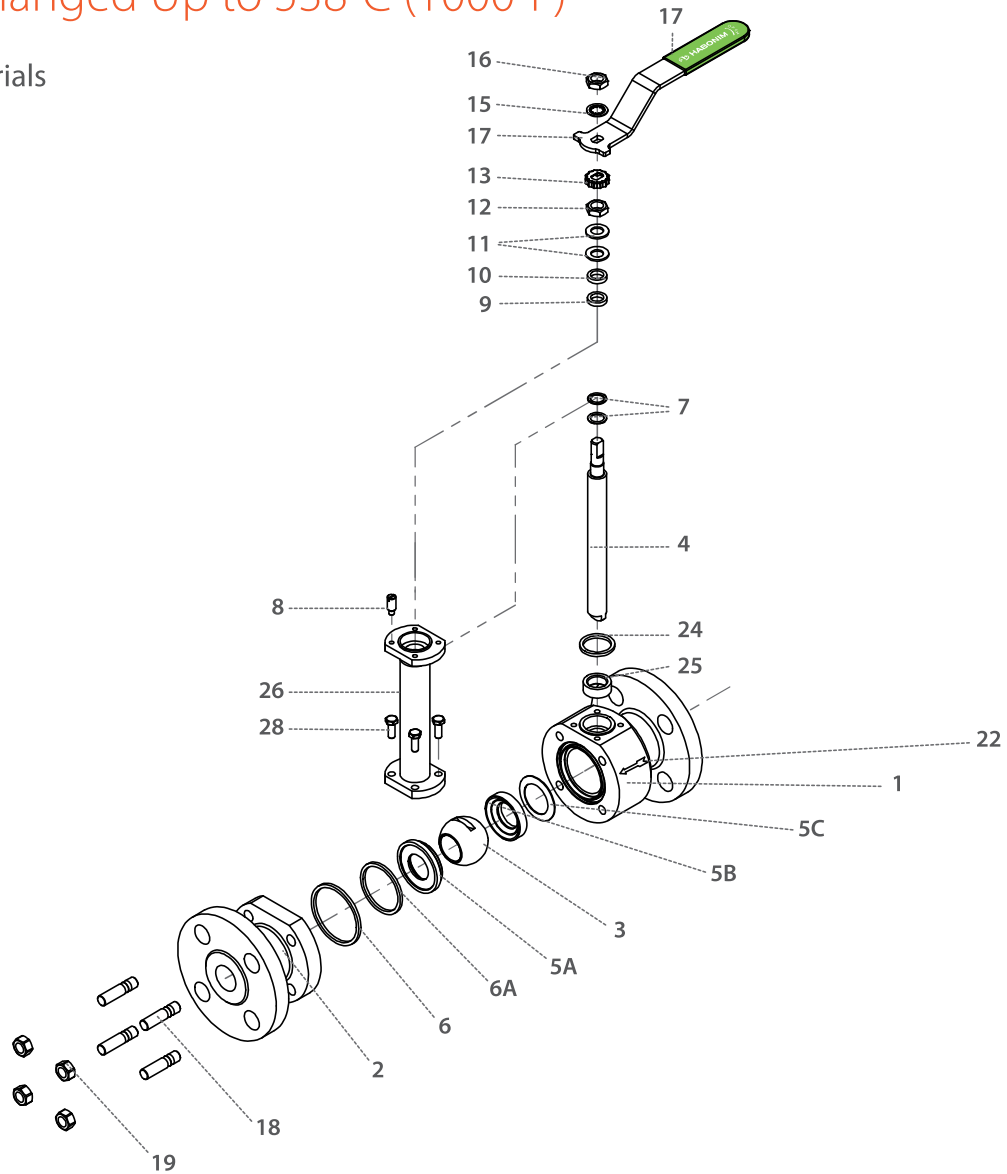

Item	Description	Material specification	Qty.
1	Body	Acc. Ordering Code	1
2	End	Acc. Ordering Code	1
3	Ball	Acc. Ordering Code	1
4	Stem	Acc. Ordering Code	1
5A	Downstream seat	Acc. Ordering Code	1
5B	Upstream seat	Acc. Ordering Code	1
5C	Upstream seat spring	Inconel 718	1
6*	Body seal	Graphite	2
6A*	Seat seal	Graphite	1
7*	Stem thrust seal	A479 316L, Hardened with LTPN, B637 N07718 Inconel 718	2
8	Stop pin	S. Steel	1
9*	Stem seal	Graphite	1
10	Follower	S. Steel	1
11	Disc spring	S. Steel	2

Item	Description	Material specification	Qty.
12	Stem nut	S. Steel	1
13	Locking clip	S. Steel	1
14	Handle	S. Steel	1
15	Serrated washer	S. Steel	1
16	Handle nut	S. Steel	1
17	Sleeve	PVC	1
18	Body bolts/studs	S. Steel	4
19	Body nuts	S. Steel	4
22	Arrow flow	S. Steel	1
23	Tag (not shown)	S. Steel	1
24	Bonnet seal	Graphite	1
25	Stem Bearing	S. Steel	1
26	Bonnet	S. Steel	1
29	Bonnet bolts	S. Steel	4-6

* Repair kit components

Z73T

Z74T

2"-8" | DN50-DN200 | CLASS 150/300

Floating Ball Flanged Up to 538°C (1000°F)

Valve dimensions

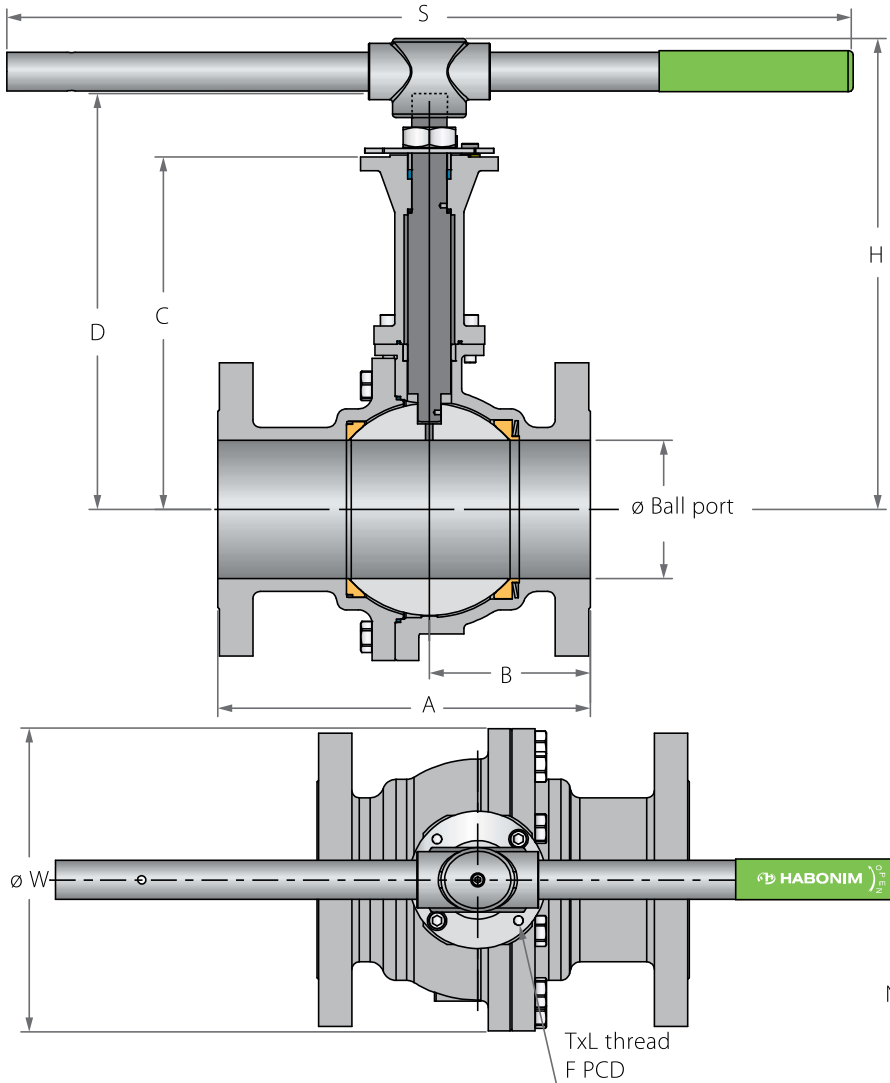

Preparation for actuation

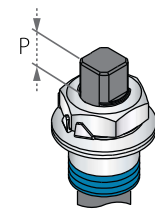

Stem groove shows valve ball position

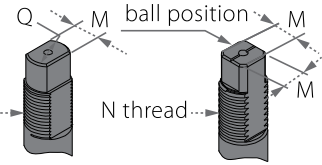

Std. port	Unit	Ball port	A		B		C	D	H	S	W		M	M DD	Q	N	P	F	TxL	Weight kg/lb		Kv
			150	300	150	300					150	300										
DN50	mm	51	178.00	216.00	69.00	75.10	222.80	264.40	290.00	256.00	127.00	127.00	-	13.90	20.00	M20x2.5	14.60 (F07)	70.00	M8x12	13.5	15.5	430
2"	inch	2.01	7.01	8.50	2.72	2.96	8.77	10.41	11.42	10.08	5.00	5.00	-	0.55	0.79		0.57	2.76		29.7	34.1	499
DN80	mm	80	203.00	282.50	77.50	96.40	260.40	307.00	347.20	401.00	190.50	210.00	18.90	15.90	22.70	1"-14 UNF-2A	16.70 (F10)	102.00	M10x20	25	32	1000
3"	inch	3.15	7.99	11.12	3.05	3.80	10.25	12.09	13.67	15.79	7.50	8.27	0.74	0.63	0.89		0.66	4.02		55.0	70.4	1160
DN100	mm	100	228.50	304.80	84.50	104.50	276.40	323.00	-	-	230.00	254.00	18.90	15.90	22.70	1"-14 UNF-2A	16.70 (F10)	102.00	M10x20	45	50.0	1830
4"	inch	3.94	9.00	12.00	3.33	4.11	10.88	12.72	-	-	9.06	10.00	0.74	0.63	0.89		0.66	4.02		99.0	110.0	2123
DN150	mm	150	394.00	403.50	163.50	174.50	382.20	451.70	-	-	328.00	328.00	28.45	23.75	35.20	1½"-12 UNF-2A	26.20 (F12)	125.00	M12x20	90	110	4380
6"	inch	5.91	15.51	15.89	6.44	6.87	15.05	17.78	-	-	12.91	12.91	1.12	0.94	1.39		1.03	4.92		198.0	242.0	5081
DN200	mm	200	457.20	501.65	242.50	240.70	495.50	608.20	-	-	343.00	381.00	35.92	35.92	46.50	2"-8 UN-2A	37.50 (F14)	140.00	M16x30	210	245	8070
8"	inch	7.87	18.00	19.75	9.55	9.48	19.51	23.94	-	-	13.50	15.00	1.41	1.41	1.83		1.48	5.51		462.0	539.0	9361

Z73T**Z74T**

2"-8" | DN50-DN200 | CLASS 150/300



Floating Ball Flanged Up to 538°C (1000°F)

Components & materials

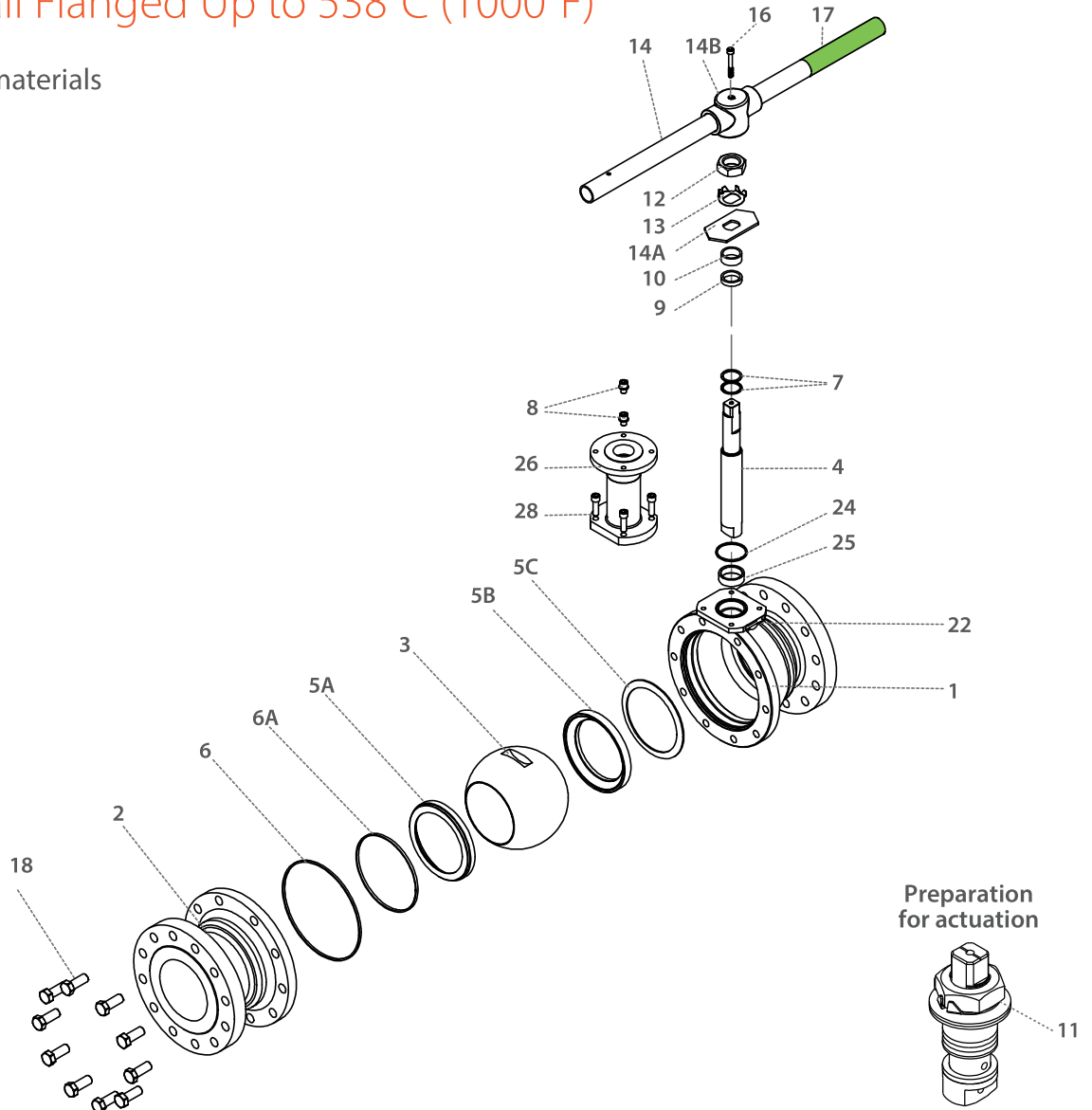

Item	Description	Material specification	Qty.
1	Body	Acc. Ordering Code	1
2	End	Acc. Ordering Code	1
3	Ball	Acc. Ordering Code	1
4	Stem	Acc. Ordering Code	1
5A	Downstream seat	Acc. Ordering Code	1
5B	Upstream seat	Acc. Ordering Code	1
5C	Upstream seat spring	Inconel 718	1
6*	Body seal	Graphite	2
6A*	Seat seal	Graphite	1
7*	Stem thrust seal	A479 316L, Hardened with LTPN, B637 N07718 Inconel 718	2
8	Stop pin	S. Steel	1
9*	Stem seal	Graphite	1
10	Follower	S. Steel	1
11	Disc spring	S. Steel	2
12	Stem nut	S. Steel	1

Item	Description	Material specification	Qty.
13	Tab lock washer	S. Steel	1
14**	Handle	S. Steel	1
14A	Stop plate	S. Steel	1
14B	Wrench head	S. Steel	1
16	Wrench bolt	S. Steel	1
17	Sleeve	PVC	1
18	Body bolts	S. Steel	8-12
22	Arrow flow	S. Steel	1
23	Tag (not shown)	S. Steel	1
24	Bonnet seal	Graphite	1
25	Stem Bearing	S. Steel	1
26	Bonnet	S. Steel	1
28	Bonnet bolts	S. Steel	4-6

* Repair kit components

** Gear operator should be used for size 4" DN100 and above (handle components are not included)

Z73

Z74

Z77

Z78



High Temperature - Ordering Code System

"Mandatory option" options are marked with **green background** | "Standard offer" options are marked with **light green background**

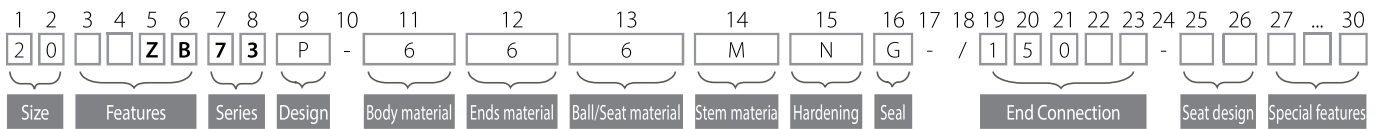

Size (1-2)		
Code	inch	mm
12	1¼"	32
15	1½"	40
20	2"	50
25	2½"	65
30	3"	80
40	4"	100
60	6"	150
80	8"	200

Up to size 1" see Z47 series

Features (3-6)	
Z	Metal seats
N	Control service

Series (7-8)	
73	ANSI #150 full port
74	ANSI #300 full port
77	DIN PN 16 full port
78	DIN PN 40 full port

Design (9)	
P	-60°C to 400°C (-76°F to 752°F)
W	-60°C to 260°C (-76°F to 500°F) HermetiX stem seal
T	-60°C to 538°C (-76°F to 1000°F)

Body/Ends material (11-12)	
6	CF8M
4	A216 C.st WCB

Ball/Seat material (13)	
6	ASTM A479 S. Steel316L
N*	St. Steel 410

* For O hardening only

Stem material (14)	
M	High Strength S. Steel
Z	Inconel 718

Hardening (15)	
N*	LTPN - Low Temperature Plasma Carbonitriding
I**	Cr3C2 - Chromium Carbide with Nickel Chrome binder - HVOF technique
O***	WC-Co - Tungsten Carbide with Cobalt binder- HVOF technique

* LTPN is standard offering up to size 2". Applicable only for P/W design

** standard offering for size 2½" and up

*** Only with N ball material

Seal Material (16)	
G	Expanded graphite
B	NBR
V	Viton
K	FFKM

End connections (19-23)	
Flanged	
150	ASME B16.5 #150 RF
300	ASME B16.5 #300 RF
PN16	EN1092 PN16 RF
PN40	EN1092 PN40 RF

Seat design (25-26)	
Blank	Type A seat design
TB	Type B seat design
TC	Type C seat design
TD	Type D seat design

Special Features (27-30)	
RTJ	Ring Type Joint
F1*	F1 - DIN 3202-1 RF face-to-face size
F4**	F4 - DIN 3202-1 RF face-to-face size
F5***	F5 - DIN 3202-1 RF face-to-face size
V30	Characterized control ball

* Up to 2"

** Up to 4"

*** 6" only