



Hydrogen Service High Pressure Floating Ball 3 Piece Threaded-Body

Technical Information

Operation

Maximum Working Pressure:
 Size 1/4"-1/2" - 500bar (7,250psi)
 Size 3/4"-1 1/2" - Class2500 414bar (6,000psi)
 Working temperature: -60°C up to +260°C (-76°F up to +500°F).

Design

- Threaded body
- Automation-ready with standard ISO 5211 connecting plate
- Total HermetiX Integrity package with:
 ISO15848-1 and API 641 emission standard certificated design
 ISO10497 and API607 fire-safe standard certificated design
 Double body sealing

Testing & Certifications

- TPED Certified, up to 414bar (6,000psi) MWP
- 100% shell & inline leak tested
- Marine classification (on demand): DNV GL, LR, BV, ABS, KR,
- RINA, others

Materials

- Stainless steel body & ends
- All materials compatible for Hydrogen use

Components & materials

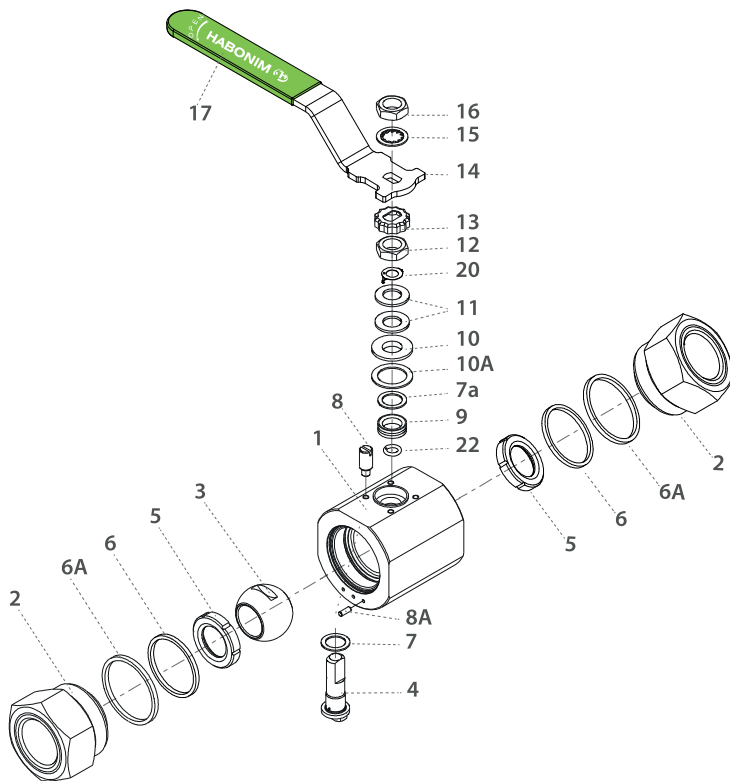

Item	Description	Material specification	Qty.
1	Body	Acc. Ordering Code	1
2	End	Acc. Ordering Code	2
3	Ball	Acc. Ordering Code	1
4	Stem	Acc. Ordering Code	1
5*	Seat	Acc. Ordering Code	2
6*	Inner seal	Acc. Ordering Code	2
6A*	Outer seal	Acc. Ordering Code	2
7*	Stem thrust seal	PEEK, CF PEEK, PCTFE	1
7a*	Anti-abrasion ring	PEEK, CF PEEK, PCTFE	1
8	Stop pin	S. Steel	1
8A	Dowel Pin	S. Steel	1
9*	Stem seal	CF PTFE, TFM	1
10	Follower	S. Steel	1
10A*	Slide bearing	S. Steel	1
11	Disc spring	S. Steel	2
12	Stem nut	S. Steel	1
13	Locking clip	S. Steel	1
14	Handle	S. Steel	1
15	Serrated washer	S. Steel	1
16	Handle nut	S. Steel	1
17	Sleeve	PVC	1
20	Anti static device	S. Steel	1
22	O-ring	Acc. Ordering Code	1
23	Tag (not shown)	S. Steel	1

* Repair kit components

H24

1/4"-1/2" | DN8-DN15 | PN500 (7,250PSI)

3/4"-1 1/2" | DN20-DN40 | CLASS 2500 PN420 (6,000PSI)

Hydrogen Service High Pressure Floating Ball 3 Piece Threaded-Body

Valve dimensions

ISO 5211 Interface

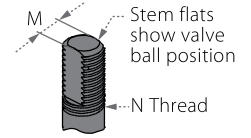
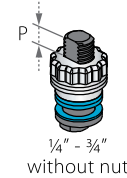
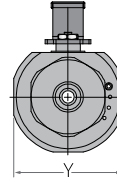
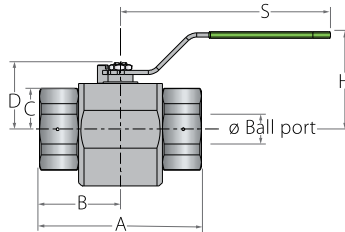
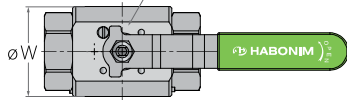

Std. port	Full port	Unit	Ball port	A	B	C	D	H	M	N	P	W	S	Y	weight kg/lb	kv cv
	DN8	mm	11.15	91	45.5	21.50	37.90	42.1	5.54	3/8" UNF	11.1	54	179	45	0.8	4.3
	1/4"	inch	0.44	3.58	1.79	0.84	1.49	1.66	0.22		0.43	2.12	7.05	1.77	1.76	5.00
DN15	DN10	mm	11.15	91	45.5	24.50	37.90	42.1	5.54	3/8" UNF	11.1	54	179	45	0.8	6.9
1/2"	3/8"	inch	0.44	3.58	1.79	0.84	1.49	1.66	0.22		0.43	2.12	7.05	1.77	1.76	8.00
DN20	DN15	mm	14.3	104.25	52.12	23.90	40.30	45	5.54	3/8" UNF	11.1	62	179	60	1.27	10
3/4"	1/2"	inch	0.56	4.10	2.05	0.94	1.59	1.77	0.22		0.43	2.44	7.05	2.36	2.79	12.00
DN25	DN20	mm	20.6	126.6	63.3	37.90	55.60	60.3	7.54	7/16" UNF	15.4	84.5	193	77	2.1	28
1"	3/4"	inch	0.81	4.98	2.49	1.49	2.19	2.37	0.29		0.60	3.32	7.60	3.03	4.63	32.00
DN32	DN25	mm	25.4	137.25	68.62	42.50	60.2	68.7	7.54	7/16" UNF	15.4	93	193	85	2.9	49
1 1/4"	1"	inch	1.00	5.40	2.70	1.67	2.37	2.70	0.29		0.90	3.66	7.60	3.34	6.39	57.00
DN40	DN32	mm	31.8	161.94	80.97	43.55	73.00	81.1	8.7	9/16" UNF	19.6	99	287	95	4.8	69
1 1/2"	1 1/4"	inch	1.50	6.37	3.18	1.71	2.87	3.19	3.19		0.77	3.89	11.30	3.74	10.58	80.00

Ordering Code System

"Mandatory option" options are marked with **green background** | "Standard offer" options are marked with **light green background**

1	2	3	4	5	6	7	8	9	10	11	12	13	14	15	16	17	18	19	20	21	22	23	24	25	26	27	28	30
0	5			F	H	2	4	W	-	6	6	M	M	L	H	G	/	N	P	T								
Size		Features			Series	Design	Body/Ends material		Ball material	Stem material	Seat material	Inner Seal	Outer Seal	End Connection			Special features											

Size (1-2)		MWP bar (psi)		
Code	inch	mm	414 (6,000)	500 (7,250)
02	1/4"	8	+	+
03	3/8"	10	+	+
05	1/2"	15	Full port	Std. port only
07	3/4"	20	+	n/a
10	1"	25	+	n/a
12	1 1/4"	32	+	n/a
15	1 1/2"	40	Std. port only	n/a

Features (3-6)	
H	Hydrogen Service
F	Fire safe
B	Full port
O	Clean assembly for O2 service

Series (7-8)	
24	HP Float 3 piece

Design (9)	
W	Total HermetiX Integrity package

Body/Ends material (11-12)	
6	S. Steel 316L

Ball material (13)	
M	High Strength S. Steel

Stem material (14)	
M	High Strength S. Steel

Seat material (15)	
L	Virgin PEEK

Inner Seal Material (16)	
H	HNBR
V	Viton
T	PTFE
G	Expanded graphite

Outer Seal Material (17)	
G	Expanded graphite
T	PTFE
H	HNBR
V	Viton

End connections (19-22)	
Threaded Ends	
NPT	ASME B1.20.1 - National Pipe Taper thread
BSPP	ISO228-1 - Pipe Parallel thread
DIN3852	DIN3852 - Pipe Parallel thread
BSPT EN 10226	10226 - Pipe Taper thread
AS5202	AS 5202 on-face gasket sealing threaded connection
MNPT	Male NPT
SAE J1926-A	SAE J1926-A
Welded	
XBW80	Extended butt weld ends (sch80)